



HAWTHORNE
MEADOWS



we'll well

The Attwell

THREE BEDROOMED FAMILY HOME

The Attwell is a superb three bedroomed house which offers 793 sq.ft. of contemporary styled accommodation including an open plan kitchen diner with patio doors opening onto the rear garden as well as a generous living room.

Hawthorne Meadows is a development of 157 homes, offering well planned and high quality housing in this superbly convenient location, close to the various amenities in Barlborough village and junction 30 of the M1 motorway.

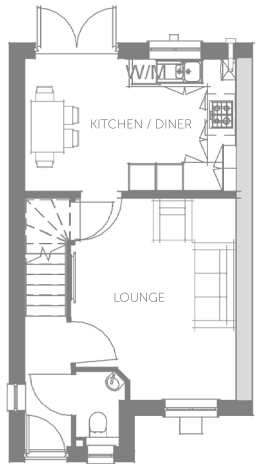

GROUND FLOOR



FIRST FLOOR

FEATURES

- New Build Family Home
- Three Bedrooms
- Ground Floor WC
- Great Family Home
- Convenient Location
- 10 Year New Build Guarantee
- Open Plan Kitchen / Diner
- Modern Bathroom
- Off Street Parking
- Coming Soon

ROOM DIMENSIONS

Ground Floor

LOUNGE	4450 x 3590 mm	14'7" x 11'9"
KITCHEN/DINER	4650 x 2950 mm	15'3" x 9'8"

First Floor

MASTER BEDROOM	4440 x 2470 mm	14'7" x 8'1"
BEDROOM 2	3280 x 2530 mm	10'9" x 8'4"
BEDROOM 3	3000 x 2120 mm	9'10" x 6'11"



HAWTHORNE
MEADOWS

www.hawthornemeadows.co.uk

Hawthorne Meadows, Chesterfield Road
Barlborough S43 4TT



WILKINS VARDY

For more details contact Wilkins Vardy

01246 270 123

info@wilkins-varDY.co.uk

